

Teste a snodo SA BEM3-4-20-501-DURBAL - BEM3-4-20-501-DURBAL

<https://www.123cuscinetti.ch/cuscinetti-supporti/teste-snodo/sa/bem3-4-20-501-durbal>

BEM3/4-20-501



male thread;
maintenance free,
dimensions in inches

**DURBAL® heavy-duty rod ends
with integral spherical
plain bearing**

rod end housing:
forged steel, tempered, rolled thread,
surface galvanized, free of Cr VI

joint ball:
ball bearing steel, hardened and ground,
surface superfinished and chromium
plated

race:
nylon / teflon / glass fibre compound

tolerances:
see page 10

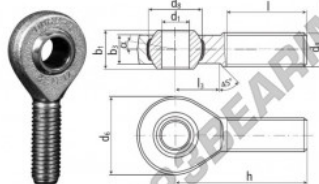

order number		measurements [inches]						
type	right hand thread / left hand thread	d ₁	d ₂ class 2	d ₃	d ₄	d ₅	h ₁	h ₂
BEM 3/4 -20	-501	.750	.7500-16 UNF	1.750	1.249	.874	.688	
		measurements [inches]			weight	basic load rating		
type	h	l	l ₃	α ₁ [°] [°]	α ₂ [°] [°]	(kg)	C _{dyn} (N)	C _{stat} (N)
BEM 3/4	2.893	1.750	1.023	11,0	7,0	0,249	24870	62175

CARATTERISTICHE DEL PRODOTTO

Marchio	DURBAL
N° Ean13	3663952510460
Diametro interno	19.05 mm
Diametro esterno	44.45 mm
Spessore	22.2 mm
Tipo	SA
Peso	249 g
Il filo	Filetto destro
Lubrificazione	senza
Imballaggio	1

contatto@123cuscinetti.ch

CRT4 de Lesquin 60 Rue Du Haut De Sainghin 59273 Fretin FRANCE