

## Teste a snodo SA BEM22-60-501-DURBAL - BEM22-60-501-DURBAL

<https://www.123cuscinetti.ch/cuscinetti-supporti/teste-snodo/sa/bem22-60-501-durbal>

### BEM22-60-501



male thread;  
maintenance free,  
adapter sizes  
according to  
DIN ISO 12240-4,  
series K



**DURBAL® heavy-duty rod ends  
with integral spherical  
plain bearing in stainless steel**

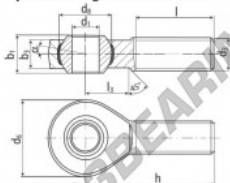

rod end housing:  
stainless steel 1.4301, rolled thread,  
surface with pickling treatment

joint ball:  
stainless steel, hardened and ground,  
surface superfinished

race:  
nylon / teflon / glass fibre compound

tolerances:  
see page 10

order number		measurements [mm]		measurements [mm]		weight		basic load rating	
type	right-hand thread	d <sub>1</sub>	d <sub>2</sub>	d <sub>3</sub>	d <sub>4</sub>	b <sub>1</sub>	b <sub>2</sub>	dyn.	stat.
BEM 22 -60	-501	22	M 22 x 1,5	54	38,05	28	20,0		
measurements [mm]		weight		basic load rating		dyn.		stat.	
type	h	l	l <sub>3</sub>	α <sub>1</sub> [°]	α <sub>2</sub> [°]	[kg]	[N]	[N]	[N]
BEM 22	84	51	26	15,5	10,0	0,440	23480	63600	

## CARATTERISTICHE DEL PRODOTTO

Marchio	DURBAL
N° Ean13	3663952509860
Diametro interno	22 mm
Diametro interno	0.866" inch
Diametro esterno	54 mm
Diametro esterno	2.126" inch
Spessore	28 mm
Spessore	1.102" inch
Tipo	SA
Peso	440 g
Il filo	Filetto destro
Lubrificazione	senza
Imballaggio	1

[contatto@123cuscinetti.ch](mailto:contatto@123cuscinetti.ch)

CRT4 de Lesquin 60 Rue Du Haut De Sainghin 59273 Fretin FRANCE