

Teste a snodo SI BEF30SO-61-501-DURBAL - BEF30SO-61-501-DURBAL

<https://www.123cuscinetti.ch/cuscinetti-supporti/teste-snodo/si/bef30so-61-501-durbal>

BEF30SO-61-501



rod end heading:
stainless steel 1.4301, rolled thread,
surface with pickling treatment

joint ball:
stainless steel, hardened and ground,
surface superfinished

race:
nylon / teflon / glass fibre compound

tolerances:
see page 10

**DURBAL® heavy-duty rod ends
with integral spherical
plain bearing in stainless steel**

female thread:
maintenance free,
adapter sizes
according to
DIN ISO 12240-4,
series K,
thread according to
ISO 8139

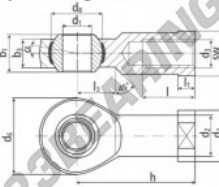

order number		measurements [mm]											
type	right hand thread	left hand thread	d ₁	d ₂	d ₃	d ₄	d ₅	d ₆	d ₇	d ₈	b ₁	b ₂	b ₃
BEF 30SO -61	-501		30	40,0	M 27 x 2	70	50	50,75	37	25,0			
measurements [mm]		weight		basic load rating									
type	h	l	l ₁	l ₂	l ₃	SW	α ₁ [°]	α ₂ [°]	β [°]	C [N]	C ₀ [N]	stat.	dyn.
BEF 30SO	110	51	15,0	35	41		17,0	10,5		1,084	33800	97100	

CARATTERISTICHE DEL PRODOTTO

Marchio	DURBAL
N° Ean13	3663952509648
Diametro interno	30 mm
Diametro esterno	70 mm
Spessore	37 mm
Tipo	SI
Peso	1084 g
Il filo	Filetto destro
Lubrificazione	senza
Imballaggio	1

contatto@123cuscinetti.ch

CRT4 de Lesquin 60 Rue Du Haut De Sainghin 59273 Fretin FRANCE