

Teste a snodo SI BEF16SO-61-502-DURBAL - BEF16SO-61-502-DURBAL

<https://www.123cuscinetti.ch/cuscinetti-supporti/teste-snodo/si/bef16so-61-502-durbal>

BEF16SO-61-502



rod end heading:
stainless steel 1.4301, rolled thread,
surface with pickling treatment

joint ball:
stainless steel, hardened and ground,
surface superfinished

race:
nylon / teflon / glass fibre compound

tolerances:
see page 10

**DURBAL® heavy-duty rod ends
with integral spherical
plain bearing in stainless steel**

female thread:
maintenance free,
adapter sizes
according to
DIN ISO 12240-4,
series K,
thread according to
ISO 8139

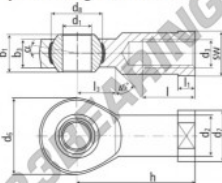

order number		measurements [mm]												
type	right hand thread	left hand thread	d ₁	d ₂	d ₃	d ₄	d ₅	d ₆	d ₇	d ₈	b ₁	b ₂	b ₃	
BEF 1650 -61		-502	16	22,0	M 16 x 1,5	42	27	28,52	21	15,0				
type		measurements [mm]										weight	basic load rating	
h	l	l ₁	l ₂	l ₃	SW	α ₁ [°]	α ₂ [°]	β [°]	C [N]	C ₀ [N]	stat.	dyn.		
BEF 1650	64	28	8,0	22	22	15,5	8,5	0,233	13760	39700				

CARATTERISTICHE DEL PRODOTTO

Marchio	DURBAL
N° Ean13	3663952509532
Diametro interno	16 mm
Diametro esterno	42 mm
Spessore	21 mm
Tipo	SI
Peso	233 g
Il filo	Filetto sinistro
Lubrificazione	senza
Imballaggio	1

contatto@123cuscinetti.ch

CRT4 de Lesquin 60 Rue Du Haut De Sainghin 59273 Fretin FRANCE