

Snodi sferici GEEW GE20-FW-2RS-DURBAL - GE20-FW-2RS-DURBAL

<https://www.123cuscinetti.ch/cuscinetti-supporti/teste-snodo/geew/ge20-fw-2rs-durbal>

GE20-FW-2RS



Description: spherical plain bearing with sliding combination steel / bronze-PTFE composite. Outer ring with two seals.

spherical plain bearing; maintenance free, according to DIN ISO 12240-1, series G

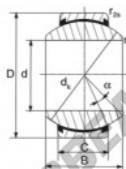

Sliding combination: steel / bronze-PTFE composite

Inner ring: bearing steel, hardened, ground and spherical surface chromium plated

Outer ring: bearing steel, hardened, ground, single split in axial direction; outer race lined with bronze-PTFE composite, lip seals on both sides

Lubrication: maintenance free

order number	measurement [mm]		
type		B	C
GE 20 FW-2RS		20	25
		20	16

type	r15 min	r25 min	measurement [mm]	D	d ₁	d ₂	α [°]	load rating C ₀ [kN]	weight [g]
GE 20 FW-2RS	0,6	0,6	42	35,5	17			127	0,150

CARATTERISTICHE DEL PRODOTTO

Marchio	DURBAL
N° Ean13	3663952502861
Diametro interno	20 mm
Diametro interno	0.787" inch
Diametro esterno	42 mm
Diametro esterno	1.654" inch
Spessore	25 mm
Spessore	0.984" inch
Tipo	GEEW
Peso	150 g
Il filo	Filetto destro
Lubrificazione	senza
Imballaggio	1
Standard	Nessuno standard

contatto@123cuscinetti.ch

CRT4 de Lesquin 60 Rue Du Haut De Sainghin 59273 Fretin FRANCE