

## Teste a snodo TPN GK45-DO-DURBAL - GK45-DO-DURBAL

<https://www.123cuscinetti.ch/cuscinetti-supporti/teste-snodo/tpn/gk45-do-durbal>

### GK45-DO



**Description:** DIN ISO Hydraulic rod end with welding slope and dowel pin at the end of rod. Made of spherical plain bearing DGE... ES (ES-2RS) pressed into rod end housing. Sliding combination steel / steel.  
Type DGK...DO-2RS with two additional seals available on request with grease nipple.

hydraulic rod ends, according to DIN ISO 12240-4, series E

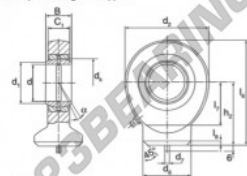

Sliding combination:

steel / steel

Inner ring:  
bearing steel, hardened, ground and phosphated

Outer ring:  
bearing steel, hardened, ground and phosphated

Lubrication:  
lubrication required

\* without grease nipple  
\*\* with grease nipple

order number	d	d <sub>1</sub>	d <sub>2</sub>	measurement [mm]			B	C <sub>1</sub>
GK 45 DO	45	50,7	102	6	58,0	32	27	

type	h <sub>1</sub>	h <sub>2</sub>	l <sub>1</sub>	l <sub>2</sub>	l <sub>3</sub>	D	d <sub>1</sub>	α [°]	load rating C <sub>0</sub> [kN]	weight [kg]
GK 45 DO	77	128,0	52,0	4,0	68	60,0	7	7	208,0	1,800

## CARATTERISTICHE DEL PRODOTTO

Marchio	DURBAL
N° Ean13	3663952501451
Diametro interno	45 mm
Diametro esterno	102 mm
Spessore	32 mm
Tipo	TPN
Peso	1800 g
Lubrificazione	con
Imballaggio	1

[contatto@123cuscinetti.ch](mailto:contatto@123cuscinetti.ch)

CRT4 de Lesquin 60 Rue Du Haut De Sainghin 59273 Fretin FRANCE