

Teste a snodo SA SAL45-ES-DURBAL - SAL45-ES-DURBAL

<https://www.123cuscinetti.ch/cuscinetti-supporti/teste-snodo/sa/sal45-es-durbal>

SAL45-ES



male thread:
lubrication
is necessary,
according to
DIN ISO 12240-4,
series E



Description: DIN ISO rod end E series. Made of spherical plain bearing DGE...E (ES) pressed into rod end body. Sliding combination steel / steel. Maintenance necessary. Bore diameter $d \geq 15$ with grease nipple in rod end body and lubrication groove and hole in inner and outer ring. Bore diameter $d \geq 15$ type DSA...ES-2RS with additional seals also available.

Ball end body:
surface zinc plated

Sliding combination:
steel / steel

Inner ring:
bearing steel, hardened, ground and phosphated

Outer ring:
bearing steel, hardened, ground and phosphated

Lubrication:
lubrication is necessary

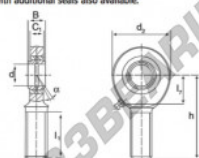

order number		measurement [mm]				
right hand thread	left hand thread	d	G	B	C ₁	d ₂
	SAL 45 ES	45	M 42 x 3	32	27,0	102

type	measurement [mm]				n [°]	load rating C ₀ [kN]	weight [kg]
	l ₁ min	l ₂	h				
SA / SAL 45 ES	94	51	163	7	240,0	2,600	

CARATTERISTICHE DEL PRODOTTO

Marchio	DURBAL
N° Ean13	3663952498591
Diametro interno	45 mm
Diametro esterno	102 mm
Spessore	32 mm
Tipo	SA
Peso	2600 g
Il filo	Filetto sinistro
Lubrificazione	con
Imballaggio	1

contatto@123cuscinetti.ch

CRT4 de Lesquin 60 Rue Du Haut De Sainghin 59273 Fretin FRANCE