

## Teste a snodo SI SIL20-T-K-DURBAL - SIL20-T-K-DURBAL

<https://www.123cuscinetti.ch/cuscinetti-supporti/teste-snodo/si/sil20-t-k-durbal>

### SIL20-T-K



female thread:  
maintenance free,  
according to  
DIN ISO 12240-4,  
series K



**Description:** DIN ISO rod end K series. Made of spherical plain bearing DG...PW pressed into rod end body. Sliding combination steel / bronze-PTFE composite.

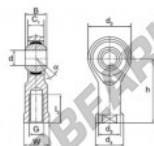

**Rod end body:**  
surface zinc plated

**Sliding combination:**  
steel / bronze-PTFE composite

**Inner ring:**  
bearing steel, hardened, ground and spherical surface chromium plated

**Outer ring:**  
brass body pressed around, outer race lined with bronze-PTFE composite

**Lubrication:**  
maintenance free

order number	right hand thread	left hand thread	d	G	B	C <sub>1</sub>	d <sub>2</sub>	d <sub>3</sub>	d <sub>4</sub>
SIL 20 T/K			20	M 20 x 1,5	25	18,00	50	27,5	34

type	measurement [mm]			h	d <sub>1</sub>	load rating C <sub>0</sub> [N]	weight [kg]
	l <sub>1</sub> min	W					
SI / SIL 20 T/K	33	30		77	14	57,0	0,420

## CARATTERISTICHE DEL PRODOTTO

Marchio	DURBAL
N° Ean13	3663952489568
Diametro interno	20 mm
Diametro esterno	50 mm
Spessore	25 mm
Tipo	SI
Peso	420 g
Il filo	Filetto sinistro
Lubrificazione	senza
Imballaggio	1

[contatto@123cuscinetti.ch](mailto:contatto@123cuscinetti.ch)

CRT4 de Lesquin 60 Rue Du Haut De Sainghin 59273 Fretin FRANCE